

7 U H Q F K % D U U L H U 6 F K R W W N \ 5 H F W

Features

- Advanced trench technology
- Low forward voltage drop
- Low power losses
- High efficiency operation
- Lead Free Finish, RoHS Compliant

Applications

- DC/DC Converters
- AC/DC Adaptors
- Switching Power Supplies
- Freewheeling Diodes

Maximum ratings and electrical characteristics (TJ = 25°C unless otherwise noted)

Parameter	Symbol	Limit	Unit
Maximum repetitive peak reverse voltage	VRRM		V
Maximum average forward rectified current	IF(AV)		A
Peak forward surge current 8.3 ms single half sine- wave superimposed on rated load per diode	IFSM		A
Operating junction and storage temperature range	TJ, TSTG	- to +150	

7 \ S L F D O W K H U P D O U H V L V W D Q F H S H U G L S G 1 0 R X Q W H G R Q) 5 3 & C A W

Notes:

3 X O V H W H V W 3 X O V H Z L G W K G X W \ F \ F O H
 3 X O V H W H V W 3 X O P W H Z L G W K 0

RATINGS AND CHARACTERISTICS CURVES (TA = 25 °C unless otherwise noted)

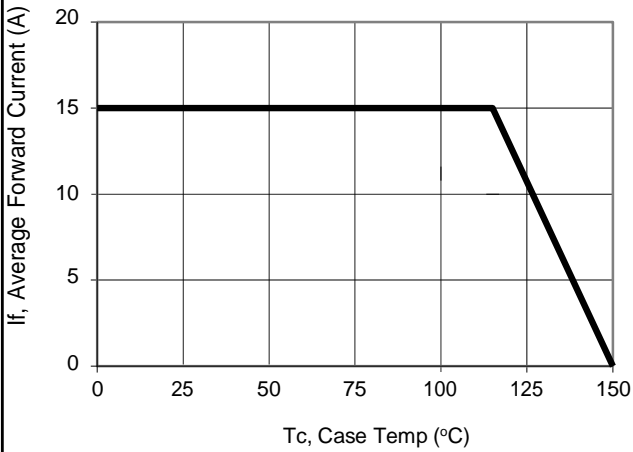

C / 5 /

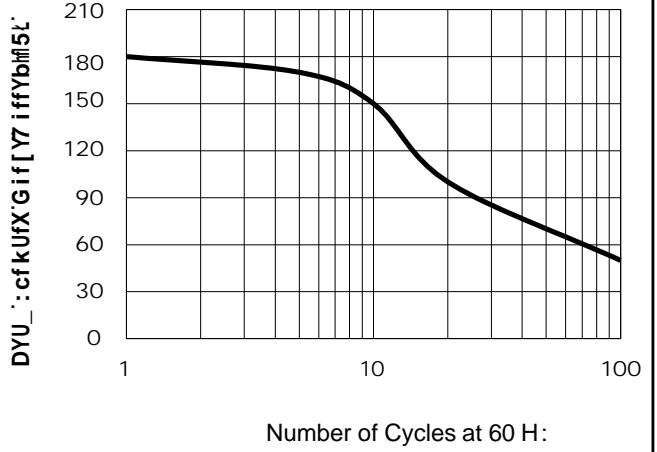
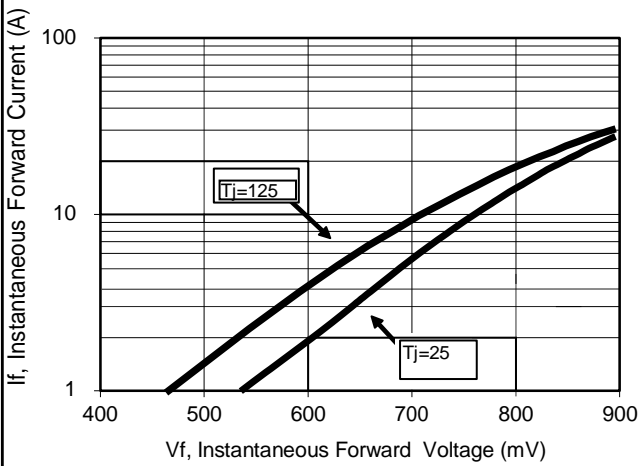
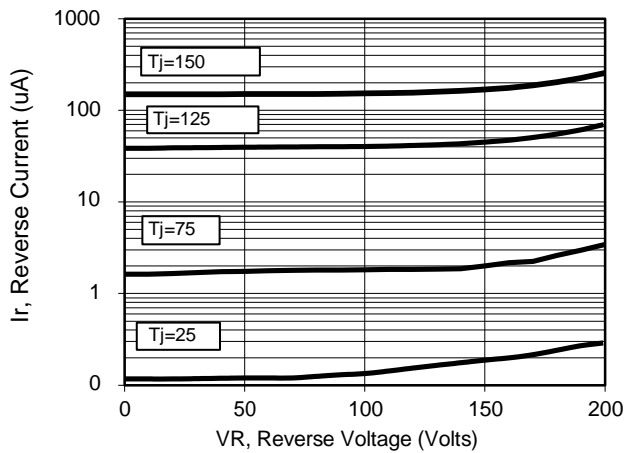

Figure2: Maximum Repetitive Surge Current



C ° C =



C ° w /

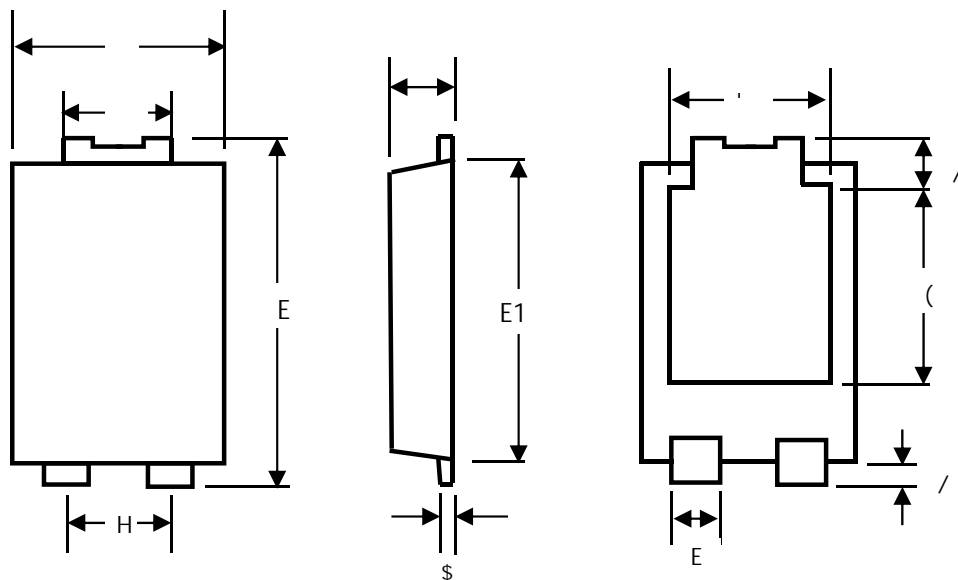

TO-277 Mechanical Data

UNIT		A	A2	1	2	D	D1	E	E1	E2	L	L1
mm	max	13	0	10	1	3	3.05)7)	""))	%"\$	\$'7
	min											
mil	max	51.1	15.75	3.37	7.0	1.3	120.0	25	22***	%'-7	'-'7	27'))
	min											

TO-277 Gi [[YghYX'DUX'@Umc i h

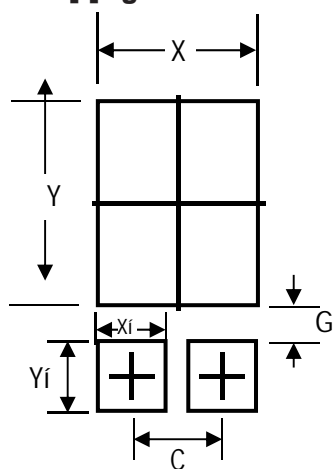

IB-T	7	;	L	L%	<	<
a a	a]b	%, \$	\$-\$	'" (%" (
a]	a]b	7, ", *	') ('	%' "' , *	') ('	

Marking Information

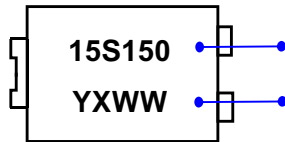

Product model :TSPFÍÛFÍ€SP Referred to as FÍÛFÍ€

PDC information

Y X WW

WW:Week code(01 to 53)

X:Internal identification code

Y:Year code(ex:0=2020)

Packaging Information

1.Reel Dimensions

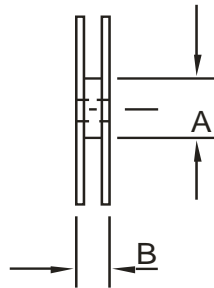
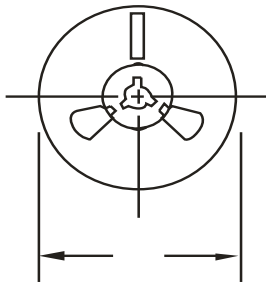

2.Inside Box

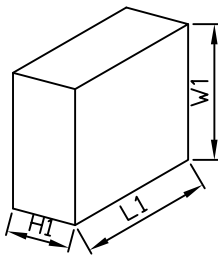

3.Outside Box

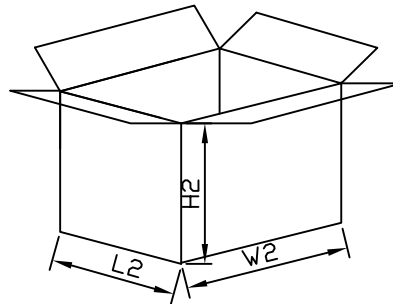

Packaging Information

NO	UNIT	Reel Dimensions			Inside Box			Outside Box		
			A	B	L1	W1	H1	L2	W2	H2
Size	mm	330	70	15	335	335	43	360	360	360
QTY	PCS	Smallest package,5000PCS/reel			10,000PCS,2 reel in total			80,000PCS/carton,8 boxes in total		
Note		Tolerance 20mm,±3mm;			21-100mm,±5mm;			101-500mm,±10mm		